

USER MANUAL – EU version

Convenience Store Displayer 180



WARNING

Read the instructions before using the machine.

KEEP THIS USER MANUAL FOR FUTURE USE!

© 2023 Fri-Jado B.V., Oud Gastel, The Netherlands.

We advise you to contact your supplier for the guarantee period and conditions. Further we refer to our General Terms and Conditions for Sales and Delivery that are available upon request.

The manufacturer does not accept any liability for damage or injury caused by failing to adhere to these regulations or by not observing the usual caution or care in actions, operation, maintenance or repair activities, even if not explicitly described in this manual.

As a result of constant commitment to improvement, it may happen that your unit deviates in detail from what is described in this manual. For this reason, the given instructions are only a guideline for the installation, use, maintenance and repair of the unit referred to in this manual.

This manual has been composed with the utmost care. The manufacturer shall, however, not be held responsible for any mistakes in this manual nor for any consequences thereof.

The user is allowed to copy this manual for own use. Further all rights are reserved and nothing in this manual may be reproduced and/or made public in any way.

Modifications:

In case of unauthorized modifications in or on the unit, every liability on the part of the manufacturer becomes null and void.

CONTENTS

1.	INTRODUCTION	4
1.1	General.....	4
1.2	Identification of the unit	4
1.3	Pictograms and symbols	4
1.4	Safety instructions	5
1.4.1	General.....	5
1.4.2	Moving (when applicable)	6
1.4.3	Outdoor use restrictions.....	6
1.5	Hygiene	6
1.6	Service and technical support	6
1.7	Storage.....	7
1.8	Disposal.....	7
2.	DESCRIPTION OF THE UNIT	8
2.1	Technical description	8
2.2	Intended use	8
2.3	Accessories	8
2.4	Parts	9
2.4.1	Overview of the unit	9
3.	INSTALLATION AND FIRST USE	10
3.1	Unpacking the unit	10
3.2	Installation and positioning.....	10
3.3	Warm through.....	11
3.4	Move.....	11
4.	OPERATION AND USE	12
4.1	Operating.....	12
4.2	Set the temperature	12
4.3	Load product.....	13
4.4	Fill the water tray	13
5.	CLEANING AND MAINTENANCE	14
5.1	Maintenance schedule	14
6.	MALFUNCTIONS AND SERVICE	15
6.1	Replace the lamp.....	16
6.2	Replace the mains cord	16
7.	TECHNICAL SPECIFICATIONS	17

1. INTRODUCTION

1.1 General

This manual is intended for the user of the CSD 180 (Convenience Store Displayer 180). The features and controls are being described, along with directions for the safest and most efficient use, in order to guarantee a long life of the unit.

All pictograms, symbols and drawings in this manual apply to all available CSD 180 (EU) models.

1.2 Identification of the unit

The identification plate can be found on the outside of the machine, and contains the following data:

- Name of the supplier or the manufacturer.
- Model.
- Serial number.
- Year of construction.
- Voltage.
- Frequency.
- Power consumption.

1.3 Pictograms and symbols

In this manual, the following pictograms and symbols are used:



WARNING

Possible physical injury or serious damage to the unit, if the instructions are not carefully followed.



WARNING

Hazardous electrical voltage.



WARNING

Danger of getting injured by hot surfaces.



SAFETY

Wear safety gloves for installation and dismantling.



Suggestions and recommendations to simplify indicated actions.



Recycling symbol.

1.4 Safety instructions



WARNING

The outside and shelves of the unit can be very hot.



WARNING

The maximum load on top of the unit may never exceed 10 kg.



WARNING

See installation instructions for grounding requirements.

1.4.1 General

The user of the unit will be fully responsible for abiding the locally prevailing safety- rules and regulations.

The unit may be operated by qualified and authorized persons only. Anyone working on or with this unit must be familiar with the contents of this manual and carefully follow all guidelines and instructions. Never change the order of the steps to be performed. The management must instruct the personnel on the basis of this manual and follow all instructions and regulations.

The pictograms, labels, instructions and warning signs attached to the unit, are part of the safety measures. They may never be covered or removed, and have to be clearly visible during the entire lifetime of the unit.

Immediately repair or replace damaged or illegible pictograms, warnings and instructions.

- To avoid short-circuiting, never clean the unit using a water hose. For cleaning instructions, see section 5.
- The shelves, glass and back of the hot unit can get hot.
- The unit must be cleaned regularly to ensure proper functioning.
- Do not store explosive substances such as aerosol cans with flammable propellant in this appliance.
- This appliance can be used by children aged from 8 years and above and persons with reduced physical, sensory or mental capabilities or lack of experience and knowledge if they have been given supervision or instruction concerning use of the appliance in a safe way and understand the hazards involved.
- Children shall not play with the appliance.
- Cleaning and user maintenance shall not be performed by children without supervision.

1.4.2 Moving (when applicable)

When moving the unit:

- Before moving the unit, first switch off the mains voltage by pulling the plug from the wall socket.
- Remove pans containing a liquid product from the unit.
- Always keep the unit in upright position.
- Make sure that the wheels can move freely, so they never touch the power lead.

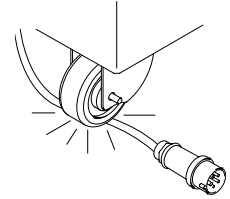

1.4.3 Outdoor use restrictions



WARNING

To avoid short-circuiting, the units may not be used outdoors or in a rainy or very moist environment.

1.5 Hygiene



WARNING

Immediately remove products in damaged packaging from the equipment and destroy the products. Clean all components that have come in contact with products from damaged packaging.

The quality of a fresh product always depends on hygiene. It is essential that products are packaged immediately after preparation. Prevent fresh raw vegetables or already prepared, cooled products from coming into contact with raw meat products to avoid transmitting salmonella. First thoroughly clean hands and / or tools that have touched raw meat.

For hot products, the core temperature of the products at packaging should at least be 85°C.

Be aware that high humidity levels may encourage the growth of biological organisms in the environment.

Refer to the cleaning instructions of section 5.

1.6 Service and technical support

The electrical schematics of your unit is included. In case of malfunctions you can contact your dealer / service agent. Make sure you have the following data available:

- Model.
- Serial number.

This data can be found on the identification plate.

1.7 Storage

If the unit will not be used temporarily, and will be stored, follow these instructions:

- Clean the unit thoroughly.
- Wrap the unit from getting dusty.
- Store the unit in a dry, non-condensing environment.
- Ensure good ventilation.
- FS and SS Humidified models: empty water tray.

1.8 Disposal

Dispose of the machine, any components or lubricants removed from it safely in accordance with all local and national safety and environment requirements.

2. DESCRIPTION OF THE UNIT

2.1 Technical description

The display warmer keeps the products warm by means of a warm airflow with a high humidity level. The fan in the display ensures an even distribution of heat. The products maintain the required quality in the display for a maximum of three hours.

The display has glass on three sides and the rear side has a reflecting rear window, allowing optimum presentation of the products

2.2 Intended use



WARNING

The display-warmer is exclusively designed for keeping warm products warm and for presenting them.

Any other use shall be considered to be not in conformity with the intended use. The manufacturer accepts no liability whatsoever with regard to loss or injury that may be the consequence hereof. The unit was built in accordance with European Guidelines and standards as specified in the CE declaration delivered with your unit. Use the unit solely in technically perfect condition and in conformity with the intended use described above.

2.3 Accessories

Your unit contains the following standard accessories:

- User manual.

For optional accessories contact customer.service@frijado.com.

2.4 Parts

2.4.1 Overview of the unit

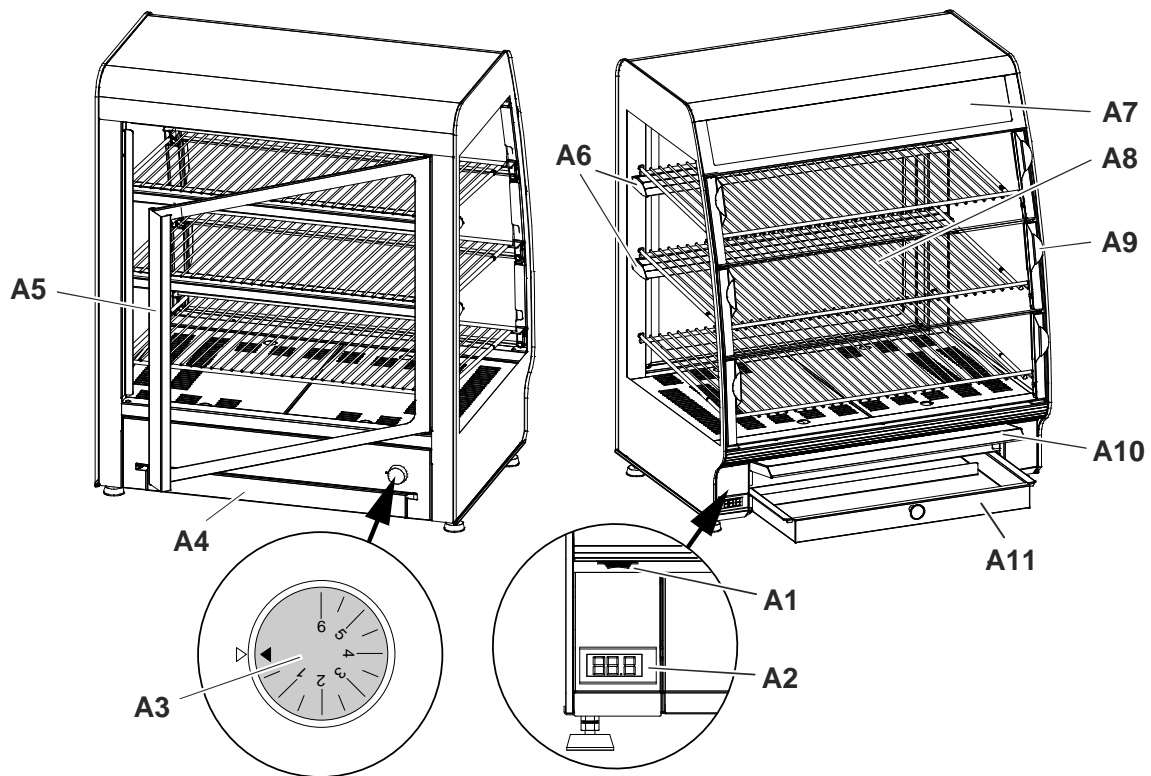

- A1 On / Off switch.
- A2 Temperature display.
- A3 Temperature setting.
- A4 Water tray rear side.
- A5 Door rear side.
- A6 Lighting beneath plateaus.

- A7 Display / slide holder and lighting of upper plateau.
- A8 Plateau (3 pieces).
- A9 Flap window customer side (3 pieces).
- A10 Covering panel of water tray.
- A11 Water tray.

3. INSTALLATION AND FIRST USE



All packing materials used for this unit are suited for recycling.

Before and during unpacking, check the state of the unit. In case of damage, store the packing material, and contact the transporter within fifteen working days after receiving the goods.

3.1 Unpacking the unit

1. Remove all parts from the unit.
2. Remove the foil from all metal parts.
3. Remove all packaging materials from the unit.
4. Check the unit for damage.
5. Make sure that all parts that belong to the model you have ordered are present.
6. Read the manual before proceeding.

If any parts are missing or damaged, contact your supplier.

3.2 Installation and positioning



WARNING

There should be at least 100 mm clearance between the sides and other equipment or walls.

Position the unit flatly on a sufficiently sturdy base using a spirit level. Here take the weight of the unit into account.



Follow the procedure below when storing a unit that will not be used for some time:

1. Thoroughly clean the unit.
2. Pack the unit dustproof.
3. Store the unit in a dry place.

Positioning

Find a suitable place for the unit.

Points of interest:

- The products in the unit must be well visible.
- There must be sufficient room to operate and maintain the unit.
- Make sure that the unit is accessible for maintenance and service activities.
- Be sure that the environmental temperature is not less than 20°C and not more than 30°C.
- In connection with the danger of short circuit the unit is not suited for use in a rainy or very moist environment.

Installation

1. Clean the inside, the removable parts and the accessories thoroughly with soapsuds before putting the unit into use.
2. After cleaning, wipe the unit with a cloth moistened with clean water to remove soapsuds residues and then dry the entire unit.
3. Attach all (optional) parts and / or accessories.
4. Insert the plug into the socket.
5. Fill the water tray with clean cold water. Preferably use softened water.



The presentation plateaus have different dimensions. A mark has been provided for easy placement. The bottom plateau has been marked with one groove, the middle plateau has two grooves and the top plateau three.

The water tray can be placed on the customer side as well as on the service side.

Install slide:

Insert a slide if the unit has been provided with a slide holder.



WARNING

Remove the plug from the outlet.

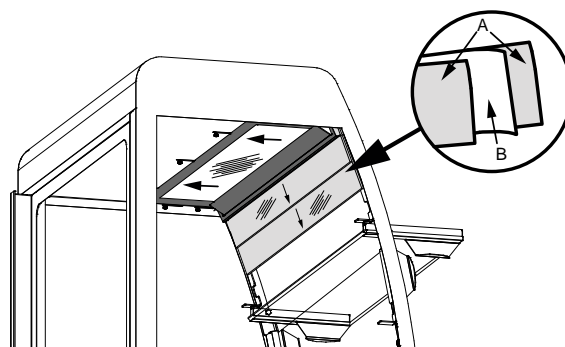

1. Loosen the 7 screws in the ceiling around the lighting, but do not remove them.
2. Carefully push against the slide holder until the lighting module cannot slide in further.
3. Remove the two transparent plastic plates (A) from the slide holder and take them out via the bottom of the unit.
4. Place the new slide (B) between the plastic plates (A) and go through the steps in reverse order.

3.3 Warm through



Let the unit warm through for at least half an hour at the highest temperature setting to allow the metal odour that exudes from it when it is new to burn off.

3.4 Move

Before moving the unit:

1. Switch off the unit.
2. Remove the plug from the outlet.
3. Let the unit cool off for fifteen minutes.
4. Empty the water tray.

4. OPERATION AND USE



WARNING

Especially an empty water tray and the lamp holder can become very hot.



The windows can mist up during the heating period: the condensation will disappear after approximately 15 minutes.

4.1 Operating

Switch on:

1. Switch on the equipment using switch A1. The lighting, the heating and the fans are activated.
2. Set the required temperature. See section 4.2.
3. Preheat the display to the required temperature for approximately 15 minutes.

Display A2 shows the temperature in the display during use.

Switch off:

1. Switch off the unit using switch A1.

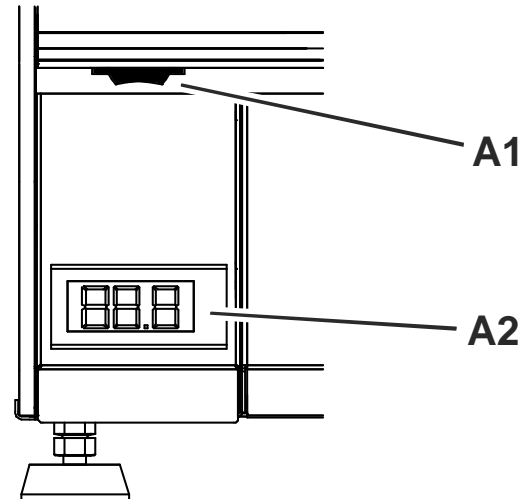

4.2 Set the temperature



WARNING

Meat products should be kept in the display-warmer at a minimum temperature of 70°C; only then you can be sure that the product temperature is above 65°C.

1. Set button A3 to the required position (1-6). See the table.

Temperature setting A3	Temperature (°C)
1	approx. 22
2	approx. 35
3	approx. 48
4	approx. 61
5	approx. 74
6	approx. 87

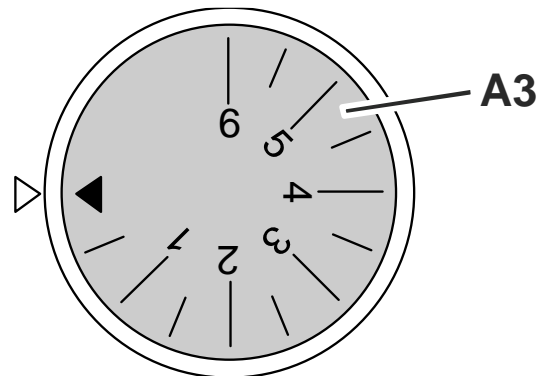

When the temperature in the display is equal to the set temperature, the heating element will switch off; the other components remain in operation.

4.3 Load product



WARNING

Only place warm products. Make sure with packaged products that the packaging material is suitable for a temperature of 100°C.

4.4 Fill the water tray

Regularly check the water level in the water tray and fill up with warm water if necessary. The water use is about 1.2 litre per hour.

Pull out the water tray before filling it. The water tray can be filled both on the service side and on the customer side.

On the customer side you can access the water tray by opening the flap at the bottom side upward.

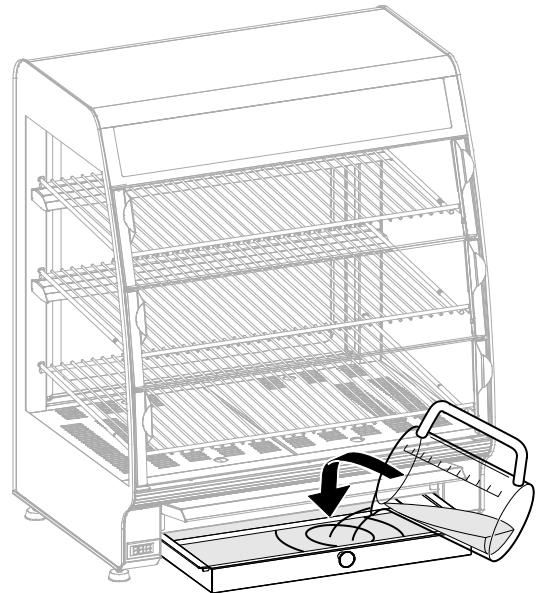

5. CLEANING AND MAINTENANCE



WARNING

Remove the plug from the wall socket when carrying out maintenance and cleaning activities.

Do not clean the unit using a water hose.



WARNING

The heating element above the water tray can still be hot!

Do not clean the unit using steel wool.

Fri-Jado Clean may in some cases irritate a sensitive skin. Wear rubber gloves when using it.

Follow the instructions on the label of Fri-Jado Clean.



In view of hygiene and an optimal condition of the unit it is important to adhere to a fixed cleaning pattern from the very beginning.

It is best to remove meat residual and grease shortly after using the unit, while it is lukewarm. Optimum cleaning results are achieved by using Fri-Jado Clean.

5.1 Maintenance schedule

Item	Action	Cleaning frequency
Interior and exterior	<ul style="list-style-type: none"> • Switch off the unit. • Take the products out of the unit. • Allow the equipment to cool off. • Clean the interior with hot soapsuds or Fri-Jado Clean. • After cleaning, dry the interior with a clean cloth. Make sure no traces of cleaning agent are left behind. 	Daily
Glass	<ul style="list-style-type: none"> • Clean the glass parts with hot water and a cleaning agent for glass. 	Daily
Presentation plateaus	<ul style="list-style-type: none"> • Clean the interior with hot soapsuds or Fri-Jado Clean. 	Daily
Water tray	<ul style="list-style-type: none"> • Clean the water tray with hot soapsuds or Fri-Jado Clean. • Remove any scaling from the water using warm water and vinegar. 	Weekly

6. MALFUNCTIONS AND SERVICE

Before you consult your dealer or the service agency when there is a fault, you can check the following points yourself:

- Is the power supply OK? Check the fuses and the earth leakage switch in the meter cupboard.
- Are all the switches in the correct position?

Item	Malfunction	Possible action
Unit	Does not function.	<ul style="list-style-type: none"> • Is the plug in the outlet? • Is the power supply OK? Check the fuses and the earth leakage switch in the meter cupboard. • Are all switches in the correct position?
Unit	The set temperature is not reached within half an hour.	<ul style="list-style-type: none"> • Close all windows.
Unit	The temperature rises too much.	<ul style="list-style-type: none"> • Check the set temperature. • Switch off the unit. • Remove the plug from the outlet. • Contact your supplier / service agency.
Lamp	A lamp is defective.	<ul style="list-style-type: none"> • Replace, see section 6.1.
Mains cord	Damaged.	<ul style="list-style-type: none"> • Replace, see section 6.2.
Window	Damaged.	<ul style="list-style-type: none"> • Replace, contact your supplier / service agency.

6.1 Replace the lamp



WARNING

Let the unit cool off for at least half an hour with all windows open.

The lamps are found in the upper cover and beneath the presentation plateaus.

1. Remove the plug from the outlet.
2. Open all windows and let the unit cool off for at least half an hour.

For the lamp in the upper cover:

3. Loosen the 7 screws in the ceiling around the lighting, but do not remove them.
4. Carefully push against the slide holder until the lighting module cannot slide in further.
5. Remove the two transparent plastic plates (A) from the slide holder and take them out via the bottom of the unit.
6. Remove the neon lamp by pulling it lengthwise out of the holder. Do this carefully to avoid breaking.
7. Replace the lamp by one of the same type and go through the steps you have just carried out in reverse order.

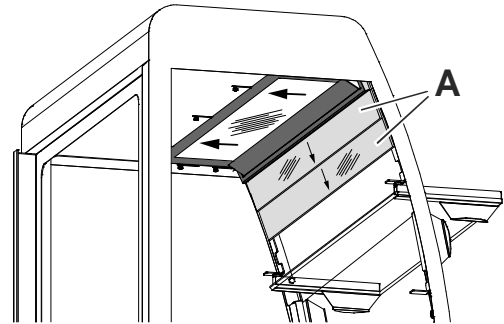

For the lamp beneath the presentation plateau:

3. Dismount the neon lamp by turning it a quarter turn.
4. Replace the lamp by one of the same type.

6.2 Replace the mains cord



WARNING

Hazardous electrical voltage.

If the power cord is damaged it must be replaced, contact your supplier or service agent.

7. TECHNICAL SPECIFICATIONS

WARNING

See the identification plate for the correct specifications of the unit. The electrical installation data may vary between different countries.

Model	CSD 180
Approved for	EU
Width	728 mm
Depth	576 mm
Height	877 mm
Weight Net Approx.	63 kg
Voltage	1N~230V
Frequency	50 / 60 Hz
Max. rated current	11,3 A
Power to be supplied	2610 W
Plug	two-pole earthed plug
Cable length	2,4 m
Sound pressure	<70 dB(A)
Water tray – Max. volume	8 L
Water tray – Max. water use per hour	1,2 L

Notes:

Notes:

Fri-Jado B.V.
Blauwhekken 2
4751 XD Oud Gastel
The Netherlands
Tel: +31 (0) 76 50 85 400

Fri-Jado Inc.
1401 Davey Road, Suite 100
Woodridge IL 60517
USA
Tel: +1-630-633-7950

www.frijado.com