

# Mounting instruction

How to mount the handshower





# Table of contents

General information	4
Target group.....	4
Technical changes.....	4
More documentation.....	4
Warranty .....	4
Permissions.....	4
 Safety information	 5
 Before replacement	 6
Tools .....	6
Spare parts .....	6
 Oven overview	 7
 Mounting the handshower	 8
Mounting the holder for the handshower .....	8
Mounting the handshower .....	9

## General information

The hand shower kit is designed to fit the Fri-Jado GO with water filters. If the handshower kit is to be mounted without a water filter or with a reverse osmosis system, you must contact your local plumber for installation.

You can connect the handshower to either filtered or unfiltered water.

### Target group

This document is aimed at service technicians who have been trained in installing and servicing the oven. The oven must only be installed and serviced by qualified service technicians.

### Technical changes

This document is subject to changes without notice.

### More documentation

You find more documentation about the oven at our website.

### Warranty

You find more information about warranty at our website.

### Permissions

Log in as "Technician" (576021) to have the necessary rights to be able to change the oven setup, use the test functions, update software, etc.

## Safety information



Read this document before using, installing or servicing the product. Installation and operation must comply with local regulations and accepted codes of good practice.



Read the safety instructions in the user manual, installation manual and service manual before you perform any work on the oven.



All maintenance and repair must be carried out by qualified installation and service technicians only. Installation and/or service by others than qualified service technicians may result in injury to the operator and/or damage to the oven.

## Before replacement

- Make sure the required tools are available.
- Unpack the spare parts and check if all parts are available.
- Make sure the working area is tidied up, clean and safe to prevent personal injury and damage to the equipment.

### Tools

- Power drill
- 3.3 mm drill
- Threader, M4
- Vacuum cleaner
- Allen screwdriver
- Scissors
- Flat screwdriver

### Spare parts

- 103574, hand shower kit

## Oven overview

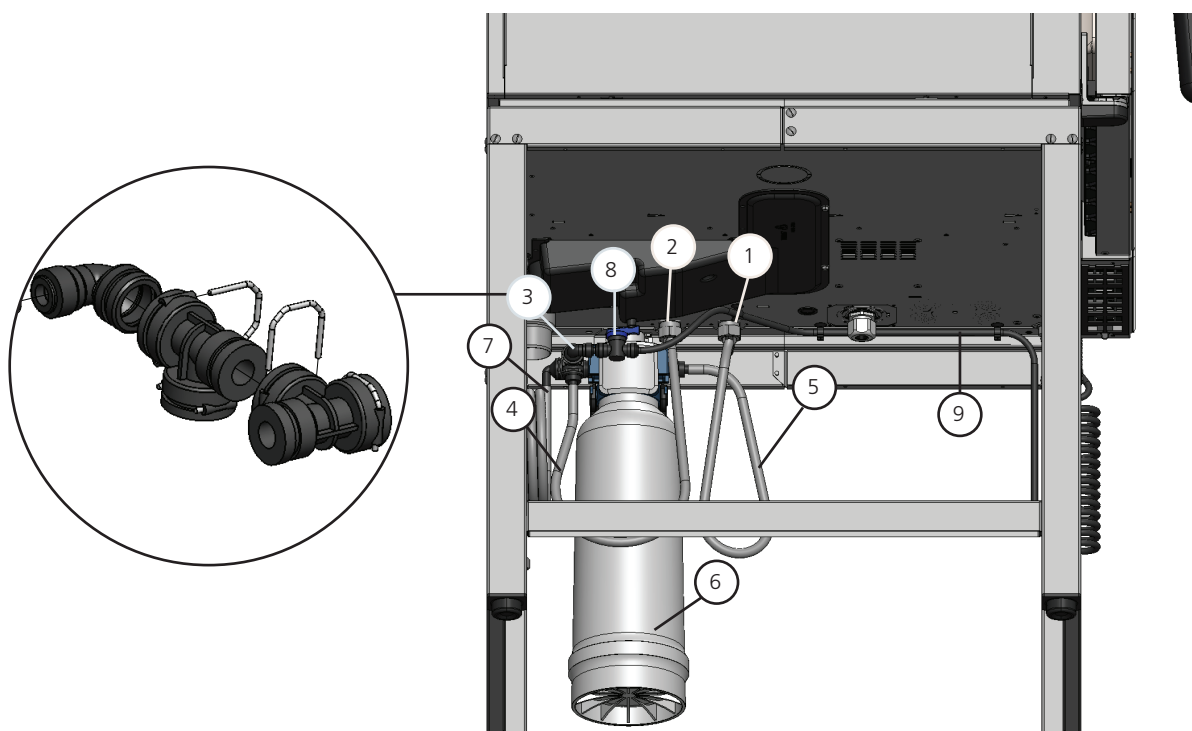

Pos.	Description	Pos.	Description
1	Inlet, solenoid valve (filtered water)	6	Water filter system
2	Inlet, solenoid valve (unfiltered water)	7	Water inlet hose, 1500 mm
3	Fittings	8	Ball valve
4	Hose, 1500 mm	9	Hose for handshower
5	Hose, 1500 mm	-	-

Table 1

## Mounting the handshower



### Mounting the holder for the handshower

1. Locate the two markings on the lower right-hand side of the oven.

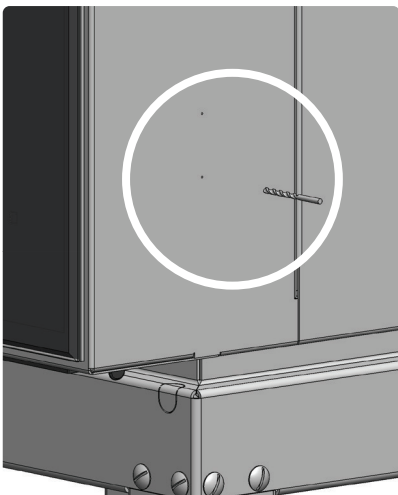

2. Drill two holes at the markings using a 3.3 mm drill.
3. Thread the two holes as M4.
4. Remove any swarfs from inside the control panel with a vacuum cleaner.



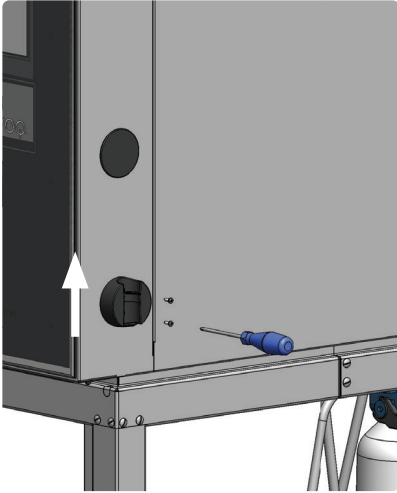

5. Fasten the holder to the right-hand side of the oven using two screws and an Allen key.

**IMPORTANT!** Make sure that you turn the holder correctly.

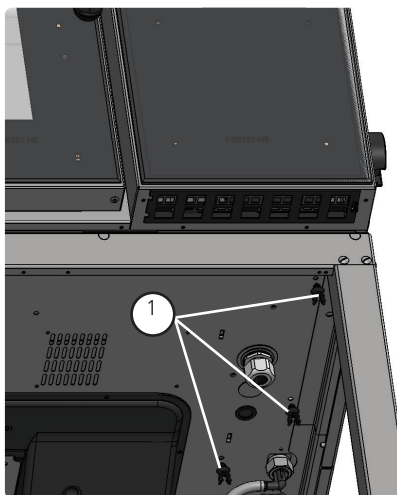

## Mounting the handshower

1. Click the three hose clips into the oven base frame.



2. Cut 50 mm of the hose for the hand shower.

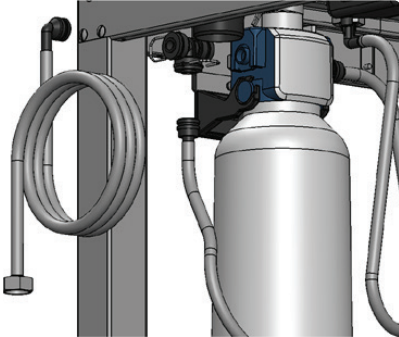

3. Take apart the hoses and the T-fittings on the non-filtered side of the water filter. Use a flat screw driver for the clips.
4. Twist the blue plastic lock on the filter head and remove the T-fitting.



5. Use the piece of hose that you have cut off to connect the handshower, ball valve and elbow fitting.
6. Connect T-fitting from the handshower kit and the T-fitting from the water filter to the elbow fitting with metal clips.

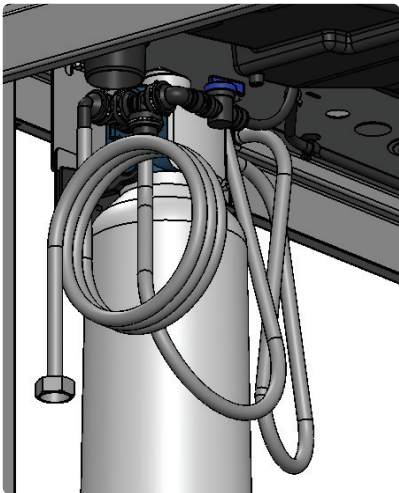

7. Mount the handshower in the holder.
8. Fasten the handshower hose in the three clips on the oven base frame.
9. Mount the handshower fittings in the water connection on the water filter.
10. Mount the water inlet hose on the T-fitting pointing backwards.
11. Mount the water connection hose to the T-fitting pointing towards the ground
12. See also "Oven overview" on page 7 for a more schematical overview.

This page is intentionally left empty.

Fri-Jado B.V.  
Blauwhekken 2  
4751 XD Oud Gastel  
North Brabant  
The Netherlands

T: +31 (0)76 508 5400  
M: [info@frijado.com](mailto:info@frijado.com)

Fri-Jado France LLC  
31 Parc du Golf – CS 90519  
350 Avenue JRGG de la Lauzière  
13593 Aix-en-Provence Cedex 3  
France

T: +33 (0)44 216 3560  
M: [fr.info@frijado.com](mailto:fr.info@frijado.com)

Fri-Jado UK Ltd.  
Ashley House  
Ashley Road UB8 2GA  
Uxbridge Middlesex  
United Kingdom

T: +44 (0)189 527 2227  
M: [uk.info@frijado.com](mailto:uk.info@frijado.com)

Fri-Jado Inc.  
1401 Davey Road  
Suite 100 Woodridge  
IL 60517  
USA

T: +1 (0)877 374 5236  
M: [us.info@frijado.com](mailto:us.info@frijado.com)

---