

Mounting instruction

Mounting a Two-GO stacking oven



Table of contents

General information	5
Target group	5
Technical changes	5
More documentation	5
Warranty	5
Permissions	5
 Safety information	 6
 Before replacement	 7
Tools	7
Spare parts	7
Estimated working time	7
 Oven overview	 8
 Stacking kit overview	 9

Mounting a Stacking oven	10
Unpacking the ovens and Stacking kit.....	10
Preparing the roof on the bottom oven for Stacking	10
Mounting the manifold assemblies for exhaust and drain.....	11
Mounting the air intake manifold on the bottom oven.....	13
Mounting the legs on top of the bottom oven	14
Mounting the upper oven on the bottom oven	17
Mounting the pipes for exhaust and drain	18
Mounting the cooling plate	21
Connecting the upper and bottom oven to electricity	22
Connecting the upper and bottom oven to the water supply.....	22
Mounting the sideplates	22
Testing the oven	23

General information

Target group

This document is aimed at service technicians who have been trained in installing and servicing the oven. The oven must only be installed and serviced by qualified service technicians.

Technical changes

This document is subject to changes without notice.

More documentation

You find more documentation about the oven at our website.

Warranty

You find more information about warranty at our website.

Permissions

Log in as "Technician" (576021) to have the necessary rights to be able to change the oven setup, use the test functions, update software, etc.

Safety information



Read this document before using, installing or servicing the product. Installation and operation must comply with local regulations and accepted codes of good practice.



Read the safety instructions in the user manual, installation manual and service manual before you perform any work on the oven.



All maintenance and repair must be carried out by qualified installation and service technicians only. Installation and/or service by others than qualified service technicians may result in injury to the operator and/or damage to the oven.

Before replacement

- Make sure the required tools are available.
- Unpack the spare parts and check if all parts are available.
- Make sure the working area is tidied up, clean and safe to prevent personal injury and damage to the equipment.
- Make sure a crane to lift the upper oven on top of the lower oven is available. Otherwise, it takes minimum two persons but preferably three or four persons to lift the upper oven on top of the bottom oven.

Tools

- Crane
- Drilling machine
- 4.2 drill
- M5 threaded tap
- 8 mm socket screwdriver
- 8 mm Allen key

Spare parts

- 107612
6-1/1 GN + 6-1/1 GN or 6 - 400x600 EN + 6 - 400x600 EN
Without fat separation system
- 107613
10-1/1 GN + 6-1/1 GN or 9 - 400x600 EN +6 - 400x600 EN
Without fat separation system
- 107685
6-2/1 GN + 6-2/1 GN
Without fat separation system
- 107695
10-2/1 GN + 6-2/1 GN
Without fat separation system

Estimated working time

The estimated working time is two hours.

Oven overview

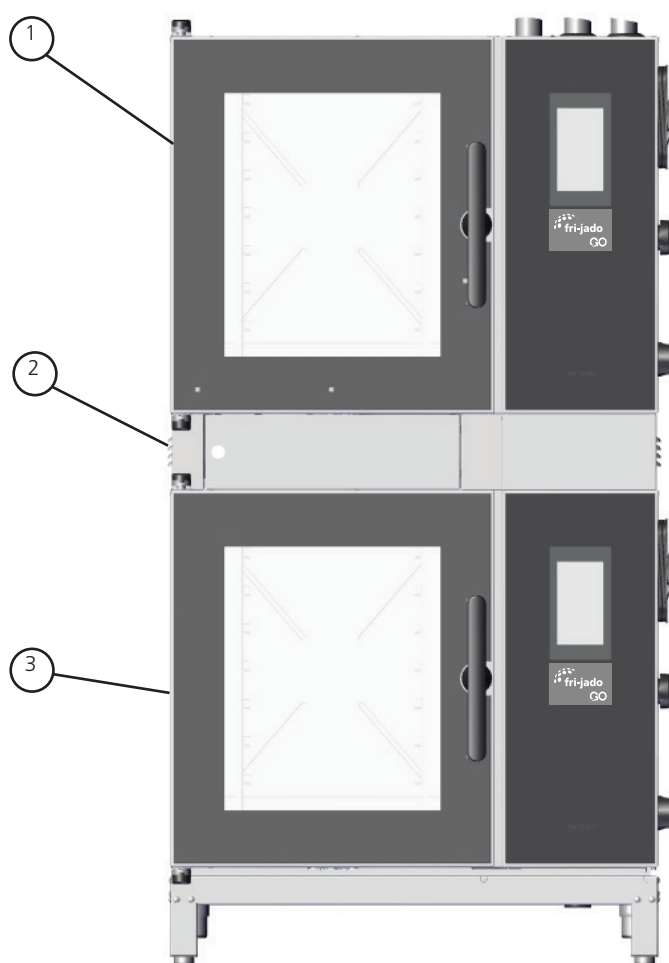

Position	Description
1	Upper oven
2	Stacking kit
3	Bottom oven

Table 1

Stacking kit overview

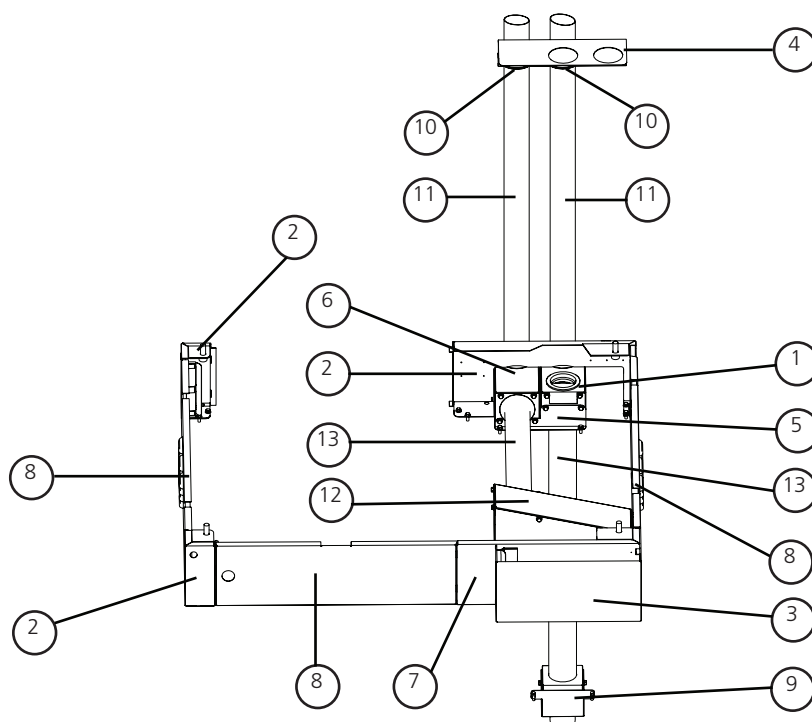

Position Description

1	Manifold assembly for drain
2	Leg
3	Cover for cooling
4	Plate for Stacking pipes
5	Bracket, H:50, W: 13, L:18
6	Manifold assembly for exhaust
7	Leg
8	Side plate for Stacking
9	Drain trap
10	Lip sealing
11	Pipe, Ø48, T:1, L:714
12	Air intake manifold
13	Pipe, Ø48, T:1, L:500

Table 2

Mounting a Stacking oven

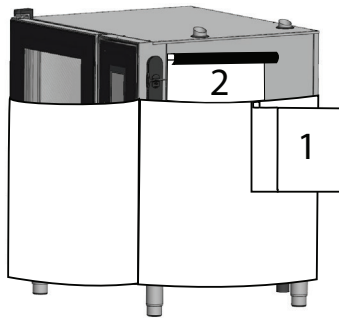

Unpacking the ovens and Stacking kit

When transporting the oven, use a pallet lifter or other appropriate lifting equipment.



DANGER

Risk of squeezing

- Never only lift the oven from the left-hand side.

IMPORTANT!

Leave the plastic film covering the oven surfaces until the oven is installed. The plastic film protects the oven surfaces from sharp objects.

1. Remove the packaging as well as the plastic film on the roof of the bottom oven.

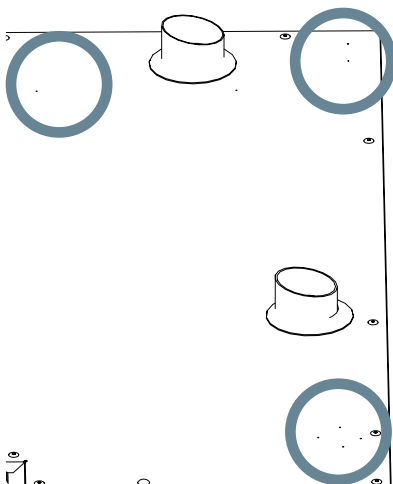

Preparing the roof on the bottom oven for Stacking

1. Drill holes in the roof of the bottom oven in the marked areas using a 4.2 drill and a M5 threaded tap.

The illustration only shows some of the markings on the rearmost, right-hand side of the oven.

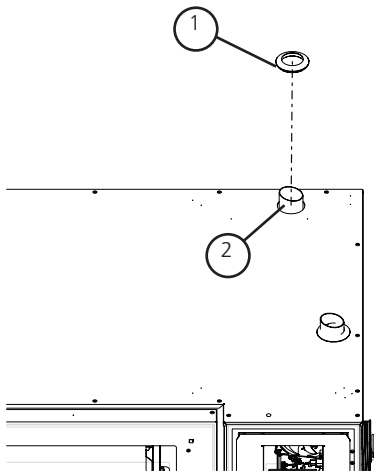

Mounting the manifold assemblies for exhaust and drain

1. Remove the lip sealing (1) from the exhaust pipe (2) on the bottom oven.

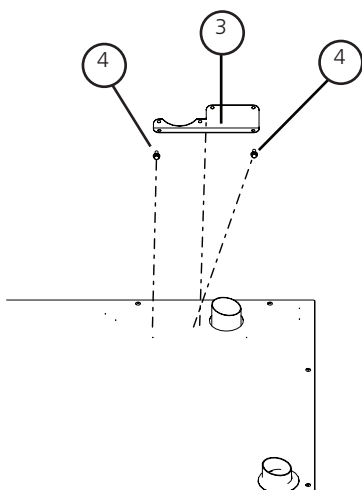

2. Mount the bracket (3) on the roof of the bottom oven using two hexagon screws M5 L:12 (4).

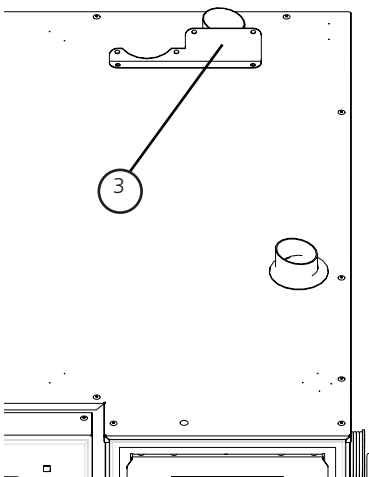

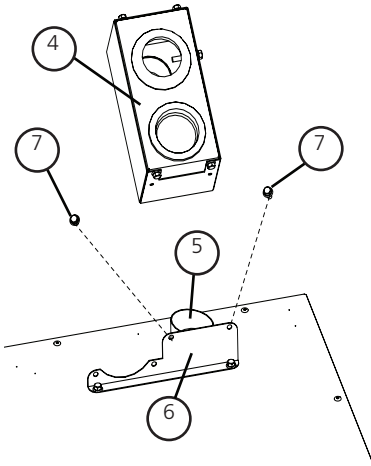

3. Place the manifold assembly for drain (4) on the exhaust pipe (5).

IMPORTANT!

Apply a silicone-based lubricant on the exhaust pipe to assure that the manifold assembly for drain easily slides onto the pipe.

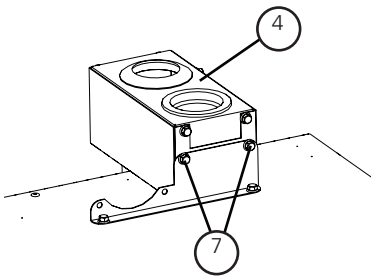

4. Fasten the manifold assembly for drain (4) to the bracket (6) using two hexagon screws M5 L:12 (7).

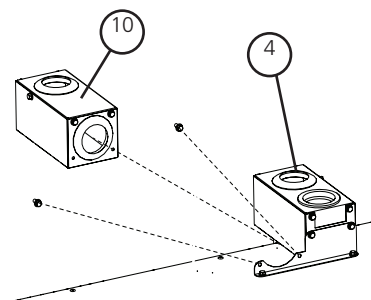

5. Place the manifold assembly for exhaust (10) next to the manifold assembly for the drain (4).

6. Fasten the manifold assembly for exhaust (12) to the bracket (13) using two hexagon screws M5 L:12 (14).

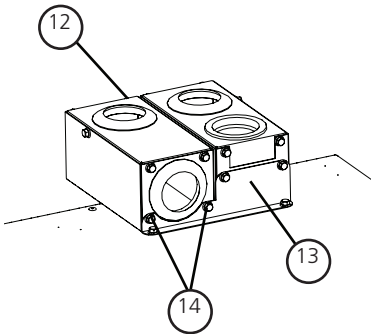

Mounting the air intake manifold on the bottom oven

1. Mount the bracket (1) for the air intake pipe (2) using two hexagon screws M5 L12 (3)
2. Mount the pipe (2) in the hole on the manifold assembly for exhaust (4).

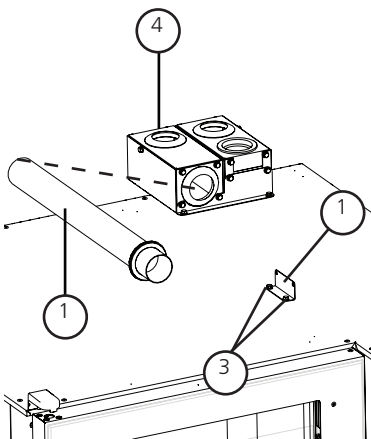

3. Place the air intake manifold (5) on the air intake pipe (6) for the bottom oven.
4. Fasten the air intake manifold using two hexagon screws M5 L:12 (7).

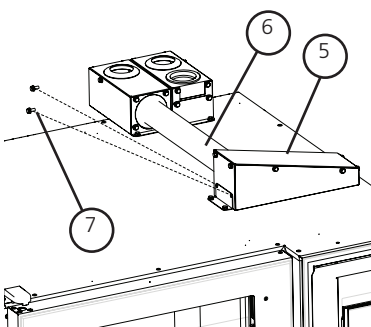

5. Mount the pipe (8) in the hole on the air intake manifold (9).

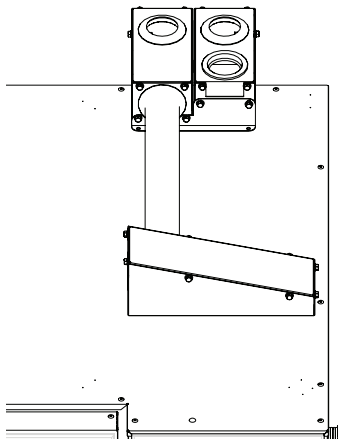
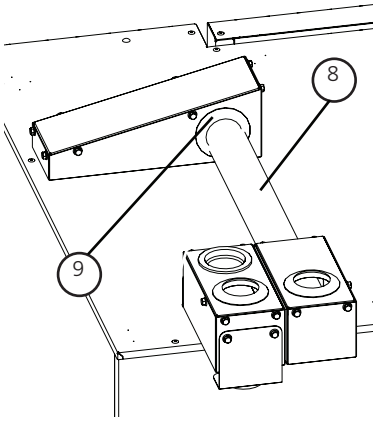

Mounting the legs on top of the bottom oven

1. Mount the leg (1) on the rearmost, left-hand side of the oven using four hexagon screws M5 L:12 (2).

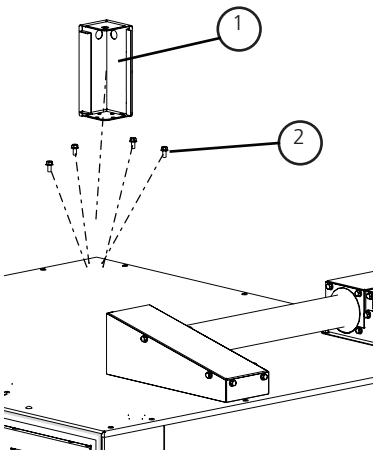

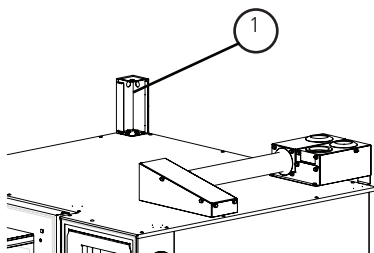

2. Mount the leg (3) on the anterior, left-hand side of the oven using four hexagon screws M5 L:12 (4).

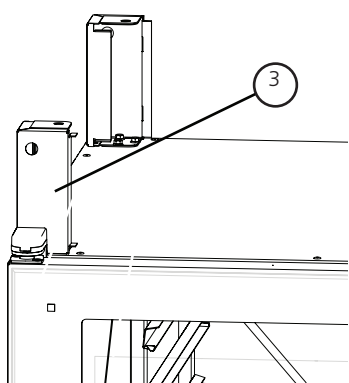
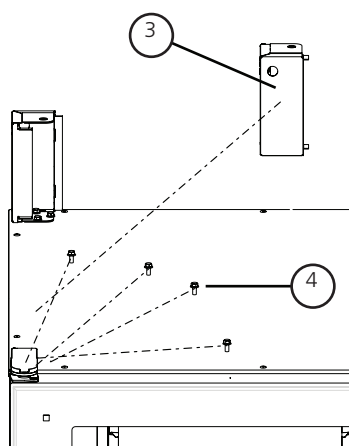

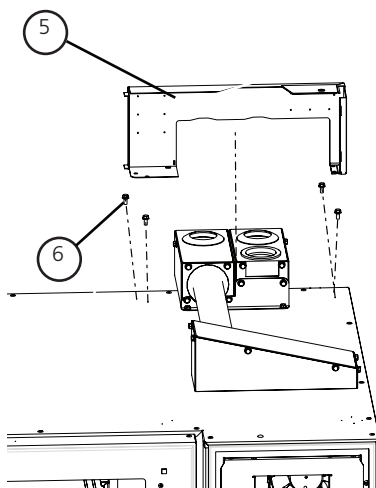

3. Mount the leg (5) on the rearmost, right-hand side using four hexagon screws M5 L:12 (6).

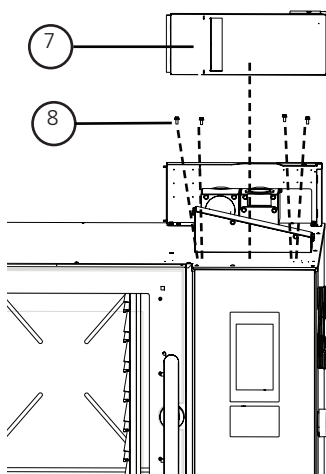
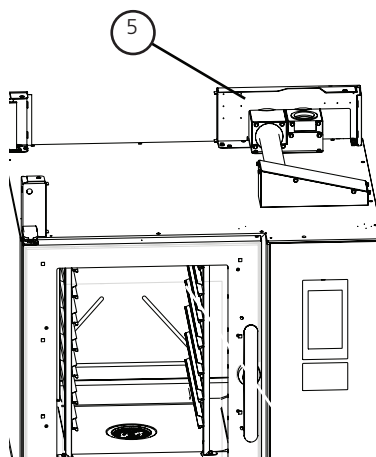

4. Mount the leg (7) on the anterior, right-hand side using four hexagon screws M5 L:12 (8).

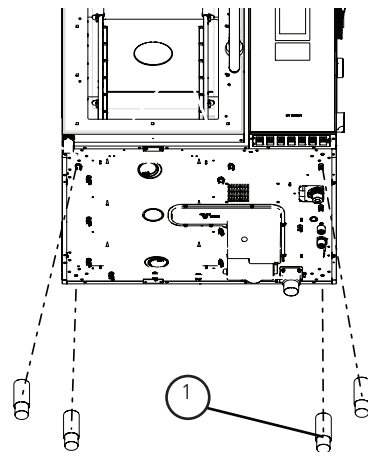
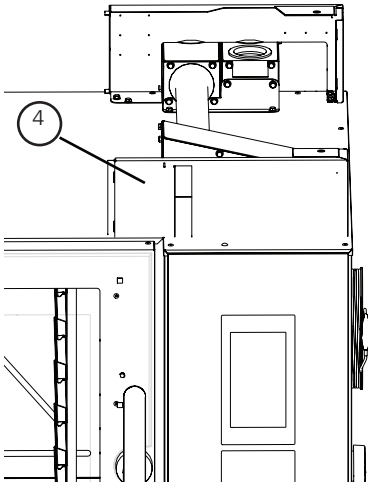

Mounting the upper oven on the bottom oven

IMPORTANT!

Make sure to mount the stand on the bottom oven before you mount the upper oven on the bottom oven. Please refer to the mounting instruction "How to mount a stand".

1. Remove the four legs (1) from the upper oven.

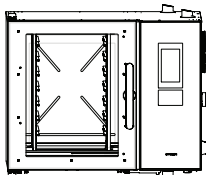

DANGER

Risk of squeezing

- Never lift the oven from the left-hand side.

IMPORTANT!

If possible, use a crane to lift the upper oven. Otherwise, the upper oven must be placed on top of the bottom oven by at least two persons but preferably three or four persons.

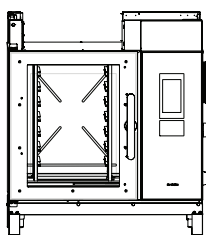

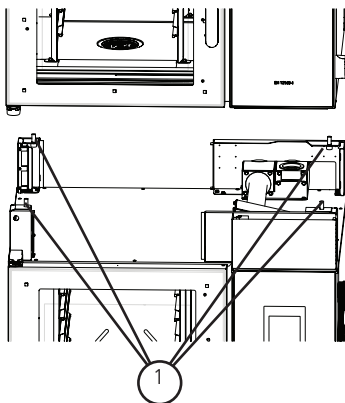

3. Lead the four Allen screws 10x25 (2) through the holes in the legs on the roof of the bottom oven.
4. Fasten the screws in the holes, where the legs were mounted, on the upper oven.

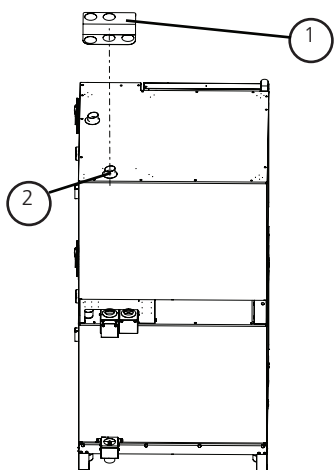
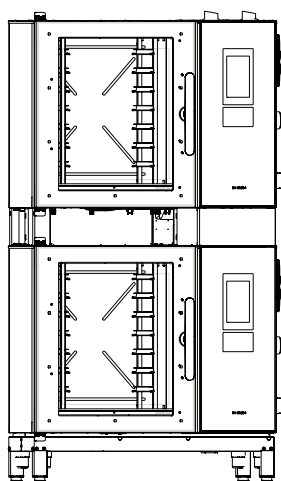

Mounting the pipes for exhaust and drain

1. Place the plate for the exhaust and drain pipes (1) on the exhaust pipe (2).

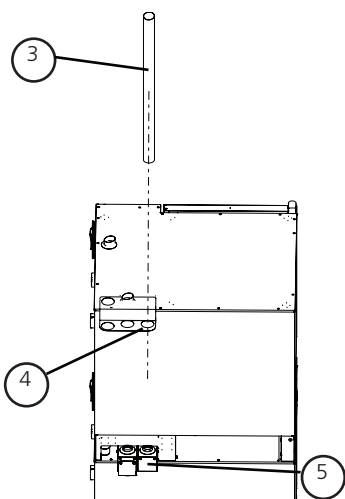
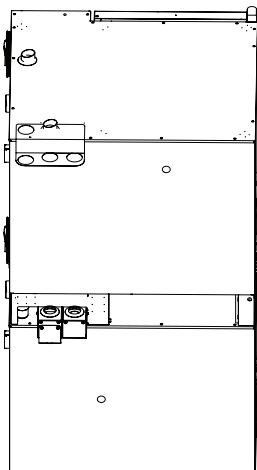

2. Slide the exhaust pipe (3) through the hole of the plate (4) and place it in the manifold assembly for exhaust (5).

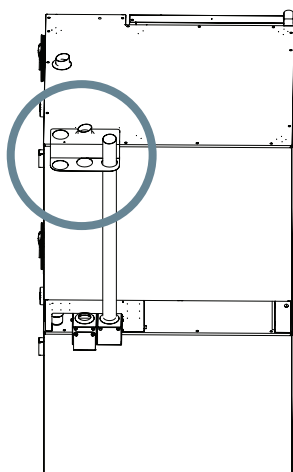

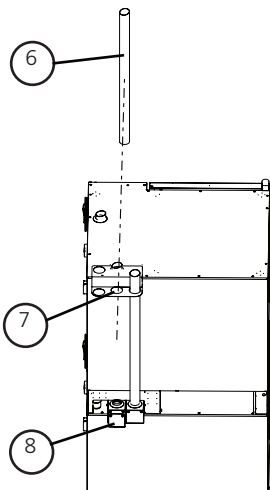

3. Slide the drain pipe (6) through the hole of the plate (7) and place it in the manifold assembly for drain (8).

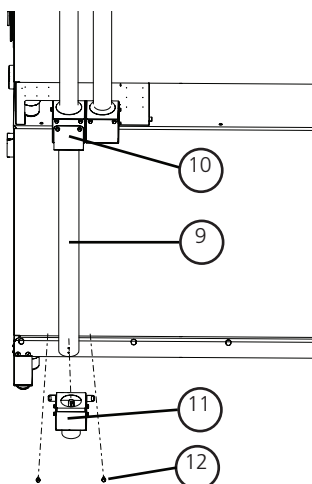
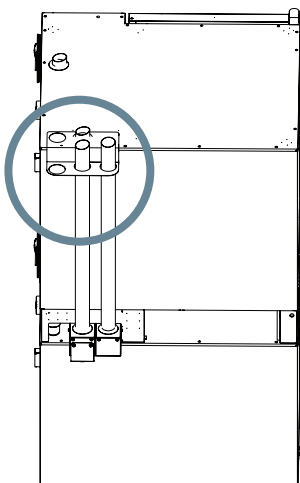

4. Place one end of the lower drain pipe (9) in the manifold for drain (10)
5. Place the other end of the lower drain pipe (9) in the drain trap (11).
6. Drill holes on the back plate of the bottom oven in the marked areas using a 4.2 drill and a M5 threaded tap.
7. Mount the drain trap (11) on the bottom oven using two hexagon screws M5 L:12 (12).

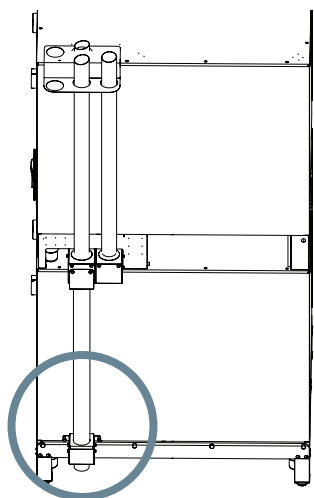

Mounting the cooling plate

1. Push the cooling plate (1) in place below the air intake filter (2) of the upper oven.

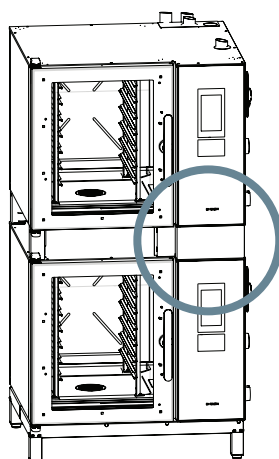
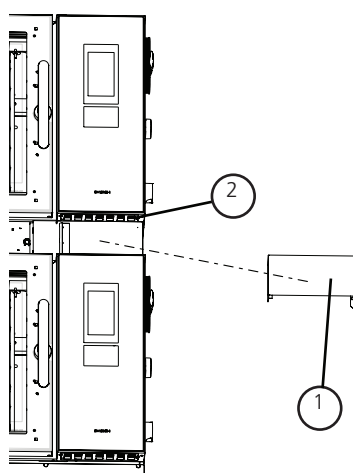

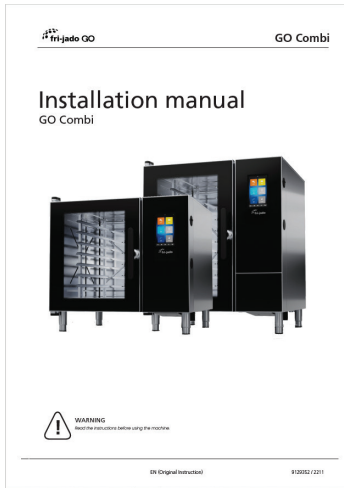

Connecting the upper and bottom oven to electricity

Follow the instructions in the installation manual regarding how to connect the oven to electricity. Both the upper and bottom oven must be connected to electricity.

Connecting the upper and bottom oven to the water supply

Follow the instructions in the installation manual regarding how to connect the oven to the water supply. Both the upper and bottom oven must be connected to the water supply.

Mounting the sideplates

1. Click the three sideplates (1) in place on the left-hand and right-hand side as well as on the front.

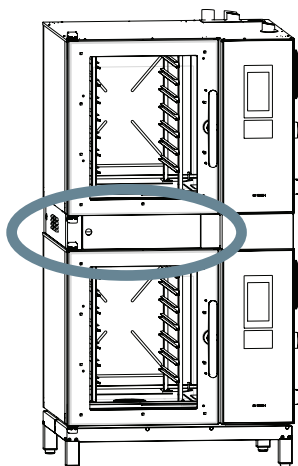
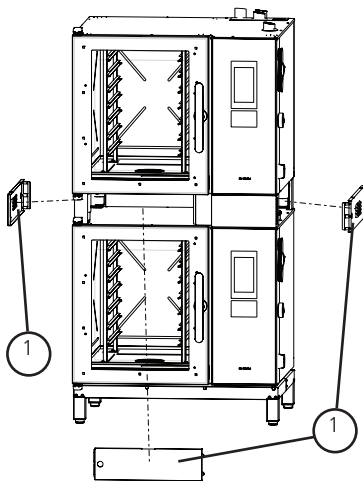



Testing the oven

Follow the installation checklist to assure that the drain connection as well as the Stacking installation are tight.

Fri-Jado B.V.
Blauwhekken 2
4751 XD Oud Gastel
North Brabant
The Netherlands

T: +31 (0)76 508 5400
M: info@frijado.com

Fri-Jado France LLC
31 Parc du Golf – CS 90519
350 Avenue JRGG de la Lauzière
13593 Aix-en-Provence Cedex 3
France

T: +33 (0)44 216 3560
M: fr.info@frijado.com

Fri-Jado UK Ltd.
Ashley House
Ashley Road UB8 2GA
Uxbridge Middlesex
United Kingdom

T: +44 (0)189 527 2227
M: uk.info@frijado.com

Fri-Jado Inc.
1401 Davey Road
Suite 100 Woodridge
IL 60517
USA

T: +1 (0)877 374 5236
M: us.info@frijado.com
