

Mounting instruction

How to mount a stand



Table of contents

General information	4
Target group.....	4
Technical changes.....	4
More documentation.....	4
Warranty	4
Permissions.....	4
Safety information	5
Before replacement	6
Tools	6
Spare parts	6
Estimated working time	6
Stand overview	7
Mounting the stand	8
Assembling the frame.....	8
Mounting the legs on a standard stand.....	8
Mounting the legs on a Stackit and table stand	9
Mounting the supports.....	9
Mounting the oven on a stand.....	10
Mounting a oven with fat separation on a stand.....	13
Mounting HydroShield water filter on the stand.....	14
Different stand models	17

General information

Target group

This document is aimed at service technicians who have been trained in installing and servicing the oven. The oven must only be installed and serviced by qualified service technicians.

Technical changes

This document is subject to changes without notice.

More documentation

You find more documentation about the oven at our website.

Warranty

You find more information about warranty at our website.

Permissions

Log in as "Technician" (576021) to have the necessary rights to be able to change the oven setup, use the test functions, update software, etc.

Safety information



Read this document before using, installing or servicing the product.
Installation and operation must comply with local regulations and accepted codes of good practice.



Read the safety instructions in the user manual, installation manual and service manual before you perform any work on the oven.



All maintenance and repair must be carried out by qualified installation and service technicians only. Installation and/or service by others than qualified service technicians may result in injury to the operator and/or damage to the oven.

Before replacement

- Make sure the required tools are available.
- Unpack the spare parts and check if all parts are available
- Make sure the working area is tidied up, clean and safe to prevent personal injury and damage to the equipment.

Tools

- Slotted screwdriver
- 8 mm socket screwdriver
- 8 mm wrench

Spare parts

The stand comes in many variations. The spare part number depends on the stand and accessories that you have ordered.

- 107954, Basic stand 1/1GN, including standard feet, with fat separation
- 107955, Basic stand 1/1GN, including standard feet without fat separation
- 107957, Basic stand 2/1GN, including standard feet with fat separation
- 107956, Basic stand 2/1GN, including standard feet without fat separation
- 107977, Stand for table and Stackit 1/1GN including standard feet with fat separation
- 106171, Stand for table and Stackit 1/1GN including standard feet without fat separation
- 107978, Stand for table and Stackit 2/1GN including standard feet with fat separation
- 106172, Stand for table and Stackit 2/1GN including standard feet without fat separation
- 107970, Floor mount
- 107971, Castors
- 107972, Racks 1/1GN
- 107973, Exterior cabinet doors 1/1GN-EN
- 107974, Exterior cabinet doors 2/1GN
- 107975, Bracket for filter
- 107976, Racks 2/1GN
- 110176, Rack support locking system

Estimated working time

Approximately 30 minutes.

Stand overview

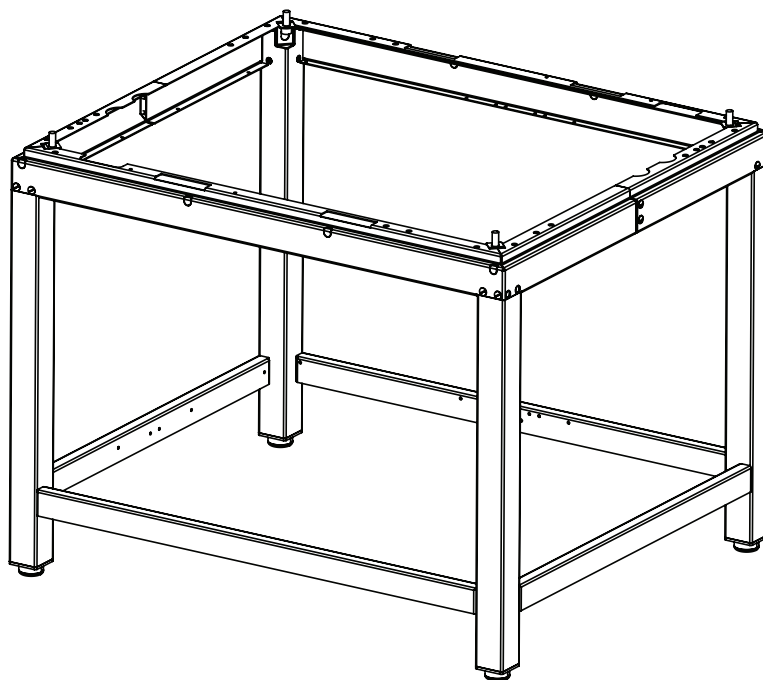

Basic stand

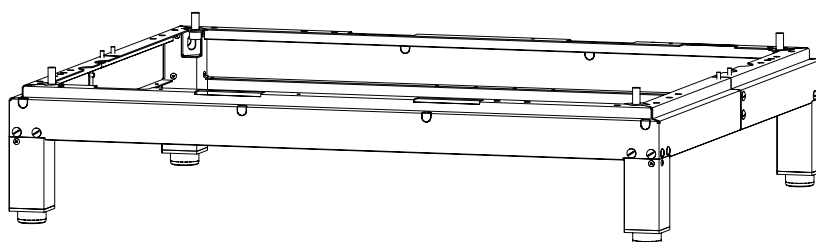

Stand for table and Stackit

Mounting the stand

Assembling the frame

1. Place the two parts of the frame on a flat surface with the bottom pointing upwards.
2. Push the two parts of the frame together
3. Fasten the two M5x10 screws on each side using a slotted screwdriver.

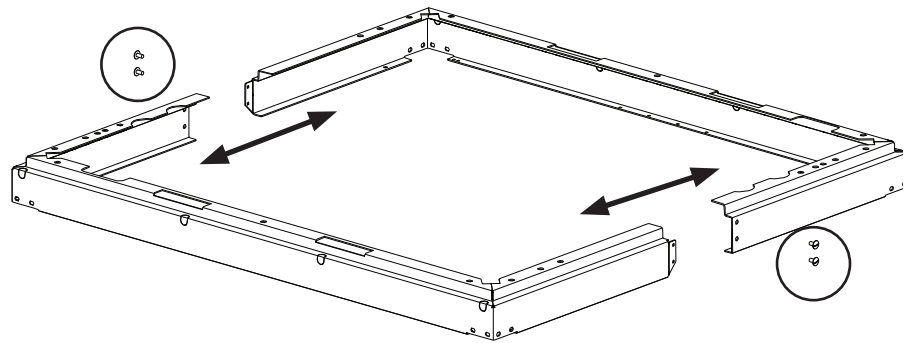

Mounting the legs on a standard stand

1. Place the frame on a flat surface with the bottom pointing upwards.
2. Place the leg in the corner of the frame and fasten it with four M5x10 screws.
3. Mount the other three legs in the same way.

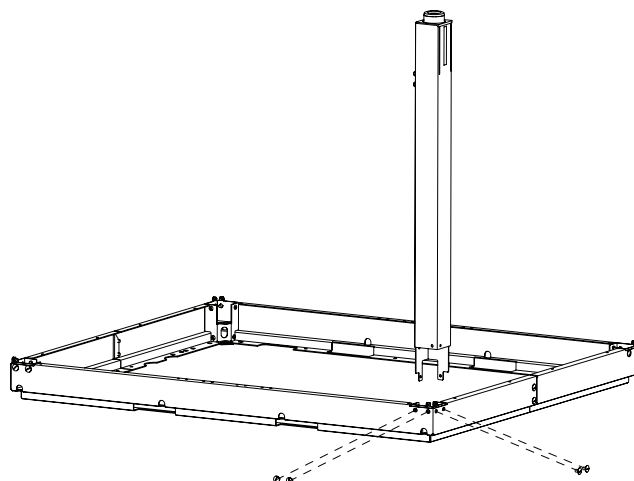

Mounting the legs on a Stacking kit and table stand

1. Place the frame on a flat surface with the bottom pointing upwards.
2. Place the leg in the corner of the frame and fasten it with four M5x10 screws.
3. Mount the other three legs in the same way.

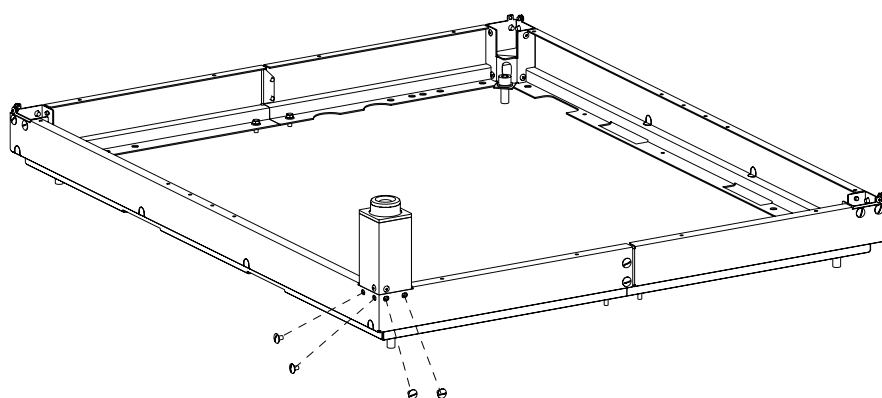

Mounting the supports

1. Place the frame with the legs pointing upwards
2. Fasten the two supports (A) on the right-hand and left-hand side with the FRH M5x12 screws using a flexible socket screwdriver.
3. Fasten the two supports (B) in the front and back in the same way as above.

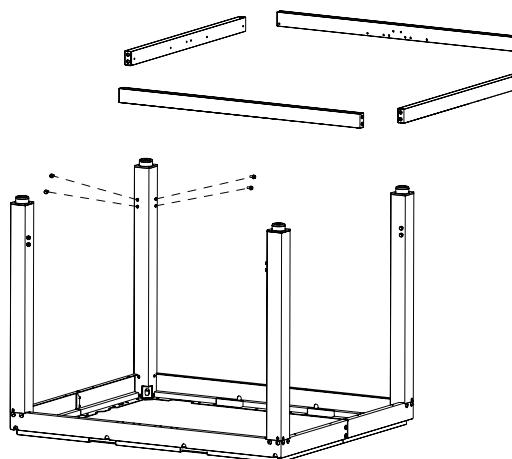

Mounting the oven on a stand



In case of a Stacking kit solution, always mount the bottom oven on the stand before mounting the upper oven on the bottom oven.

1. Detach the hose for the drip tray.

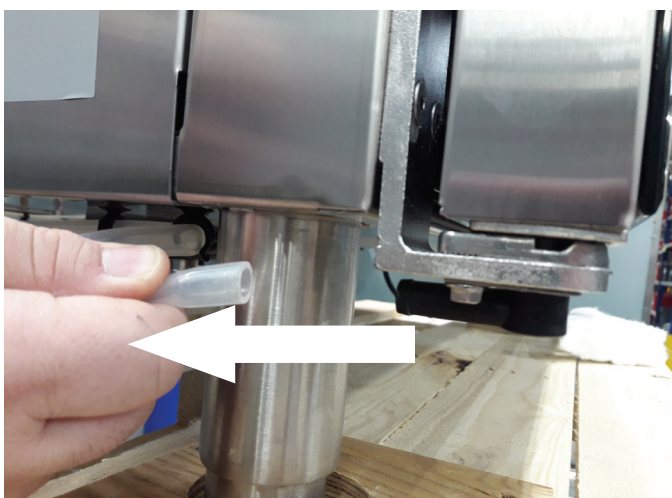

2. If the oven is a table model, remove the four legs from the oven.

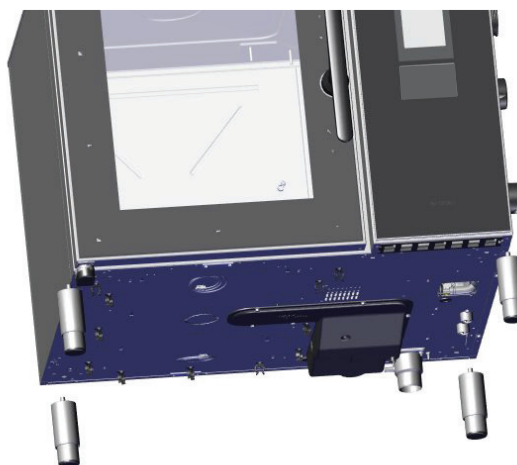

3. Place the oven on the stand.
4. Fasten the oven to the stand using 4 x hex screws and 4 x washers.
The illustration below shows how to mount the oven on a standard stand. The procedure is the same for mounting a stand on a table or Stacking model.

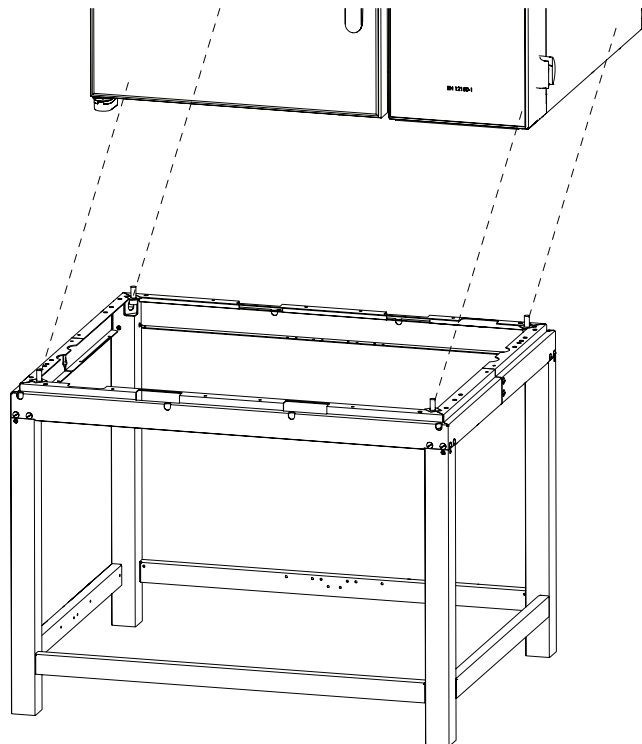

5. Fasten the two M5x10 screw on both the right-hand and left-hand side of the oven.

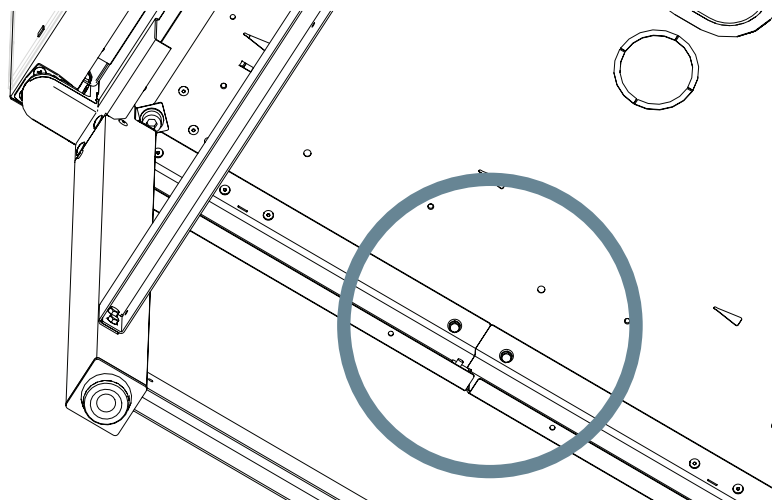

6. Attach the hose for the drip tray.



Mounting an oven with fat separation on a stand



In case of a Stacking kit solution, always mount the bottom oven on the stand before mounting the upper oven on the bottom oven.

1. Follow step 1-3 in section "Mounting the oven on a stand".
2. Fasten the oven to the stand using 4 x hex screws and 4 x washers as well as 2 x M5x10 screws.

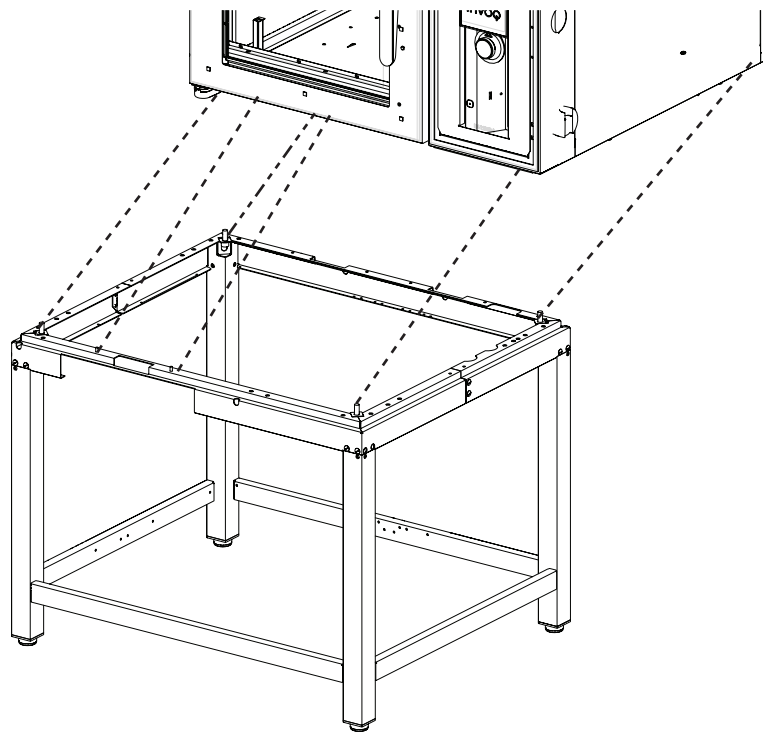

3. Follow step 5 and 6 in section "Mounting the oven on a stand".

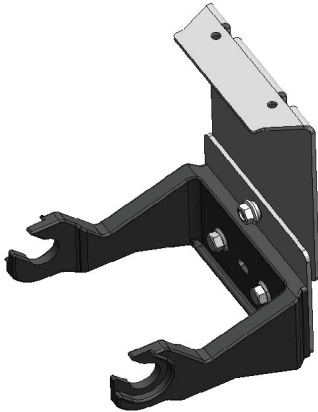

Mounting water filter on the stand



Not roll-in and Stacking kit.

The water filter can be mounted on the oven stands for the following oven types:

- Fri-Jado GO 6-1/1 GN
- Fri-Jado GO 10-1/1 GN
- Fri-Jado GO 6-2/1 GN
- Fri-Jado GO 10-2/1 GN

On all other oven types and sizes, the water filter must be placed on the floor next to the oven.

1. Fasten the bracket with 5 mm screws.
2. Remove the two M5 screws.

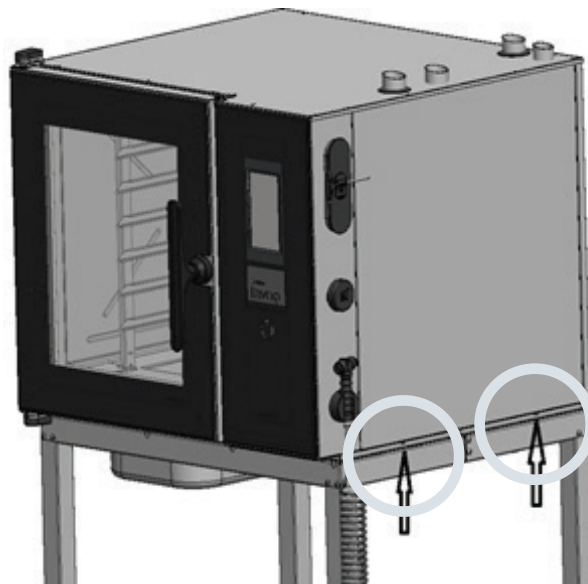

3. Remove the side plate.

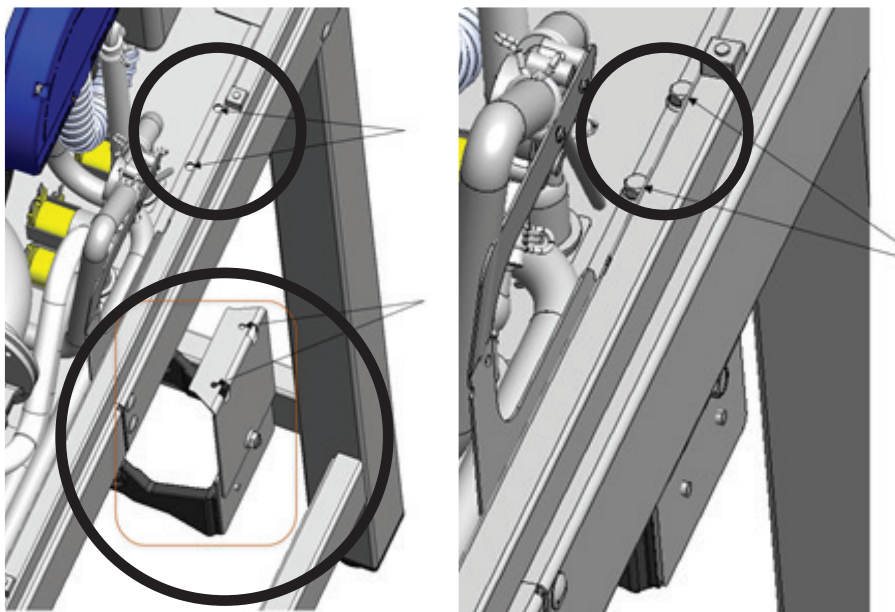

4. Fasten the brack beneath the oven. Use two M5 screws.

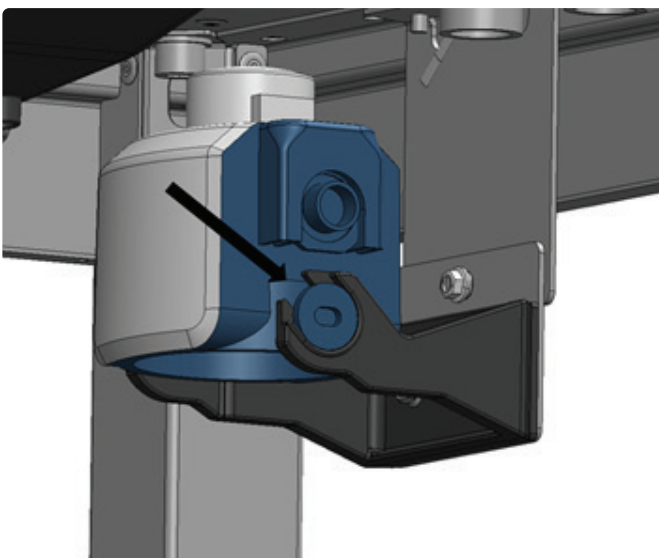

5. Slide the filter head into the bracket.
6. Mount the filter on the filter head by turning the filter counterclockwise into the filter head.

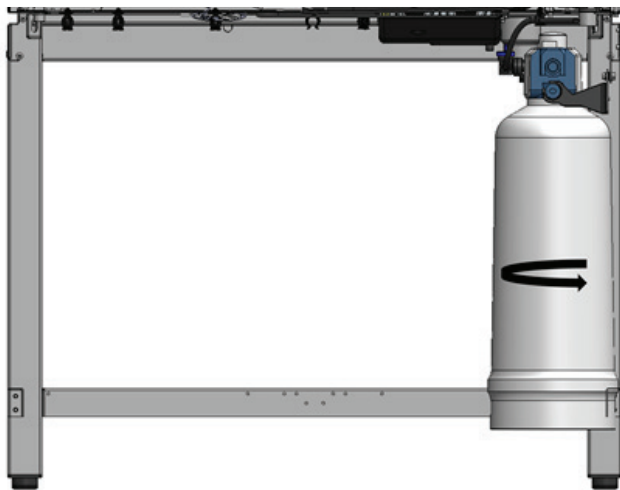

7. Connect the hoses according to the section "Connecting the oven to a Water filter" in the installation manual.

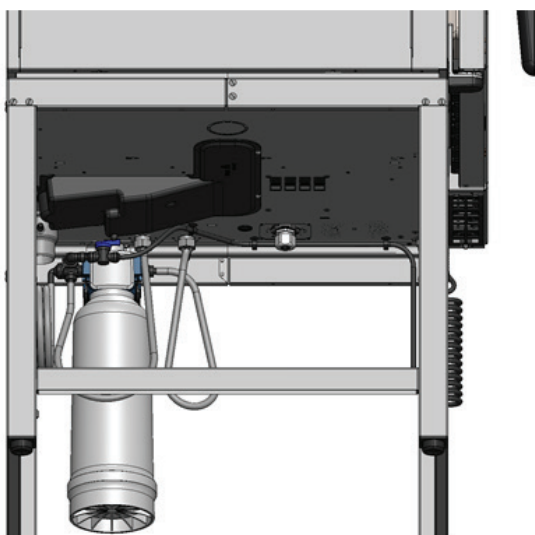

Different stand models

You can buy different accessories to the basic stand. The table below shows the different possibilities as well as which pre-drilled holes to use when mounting the racks.

Type of rack

Position of pre-drilled hole

1/1 GN

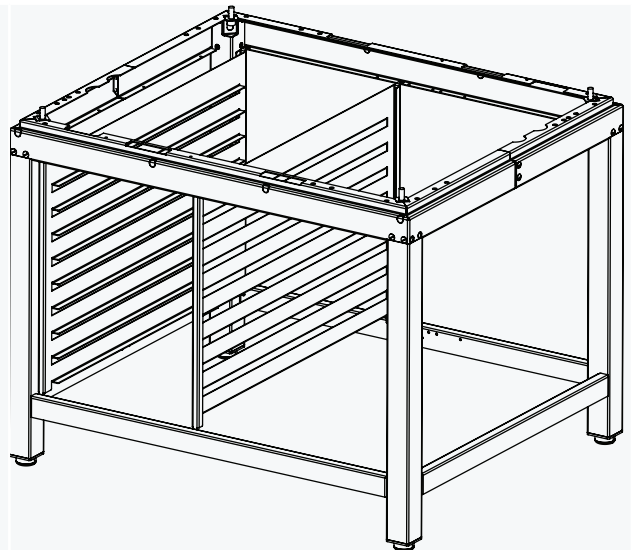

2/1 GN

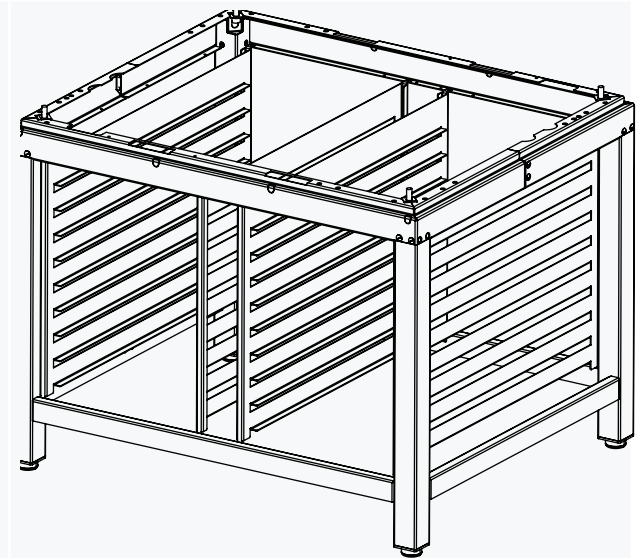

Type of rack

400x600 EN

Position of pre-drilled hole

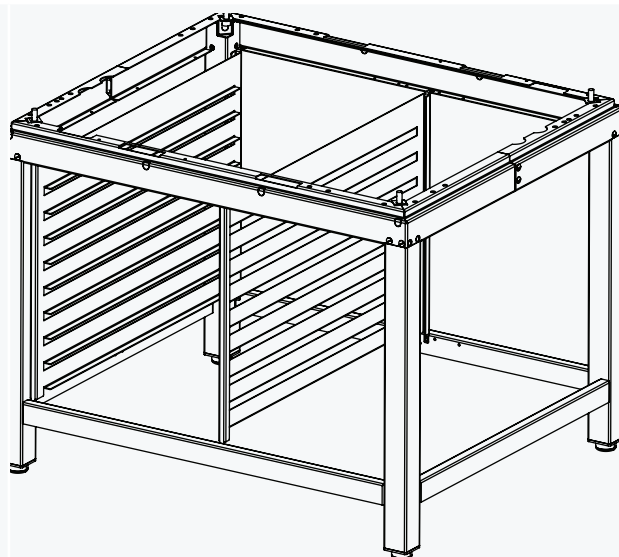

US sheet

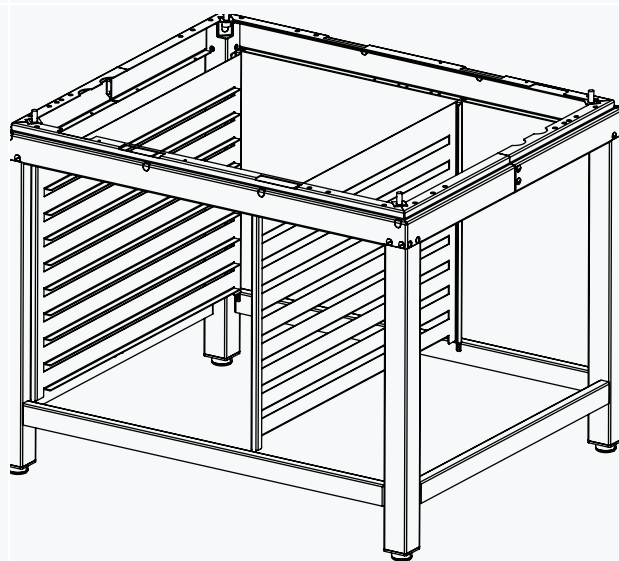

Type of rack	Position of pre-drilled hole
Cabinet	
Castors	
Floor mounting feet	
Rack support locking system	

Table 1

Fri-Jado B.V.
Blauwhekken 2
4751 XD Oud Gastel
North Brabant
The Netherlands

T: +31 (0)76 508 5400
M: info@frijado.com

Fri-Jado France LLC
31 Parc du Golf – CS 90519
350 Avenue JRGG de la Lauzière
13593 Aix-en-Provence Cedex 3
France

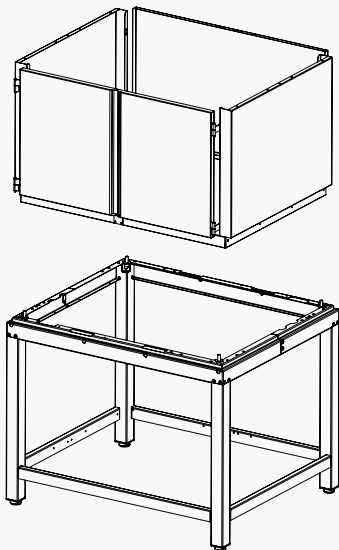
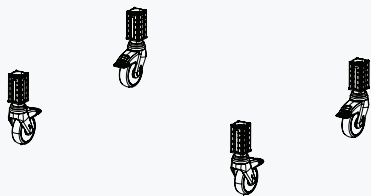
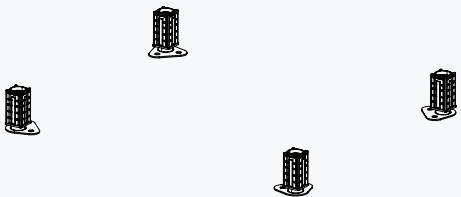
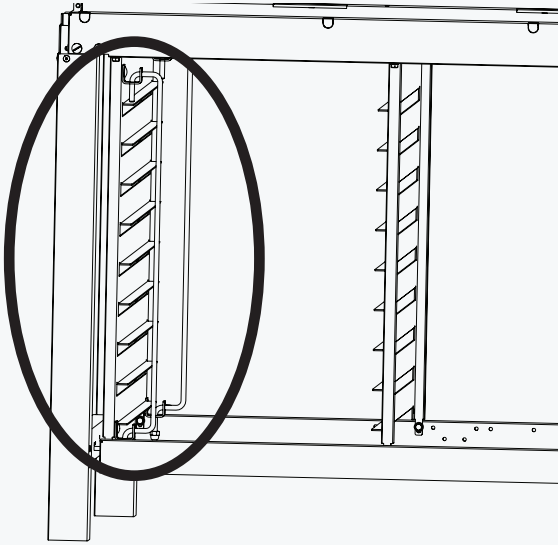
T: +33 (0)44 216 3560
M: fr.info@frijado.com

Fri-Jado UK Ltd.
Ashley House
Ashley Road UB8 2GA
Uxbridge Middlesex
United Kingdom

T: +44 (0)189 527 2227
M: uk.info@frijado.com

Fri-Jado Inc.
1401 Davey Road
Suite 100 Woodridge
IL 60517
USA

T: +1 (0)877 374 5236
M: us.info@frijado.com
