

Doc. Nr.	Rev.	Registration form.
		<b>Service instruction replacement</b>
<b>9123719</b>	<b>0</b>	<b>rotor drive motor TDR7/8 ac + LDR8 ac</b>



The service instruction is applicable for service kit 9310070s and 9340105s.

Contents service kit 9310070s for TDR7/8 ac:

9310070	1x	Ass. rotor drive
3701228	1x	Capacitor 2,5 µF
9312002	1x	Shaft seal 5 holes
9314202	1x	Silicone disc Ø100
9191050	5x	Hexagon screw M5x18
9123719	1x	This instruction

9314202



9312002



9191050 (5x)

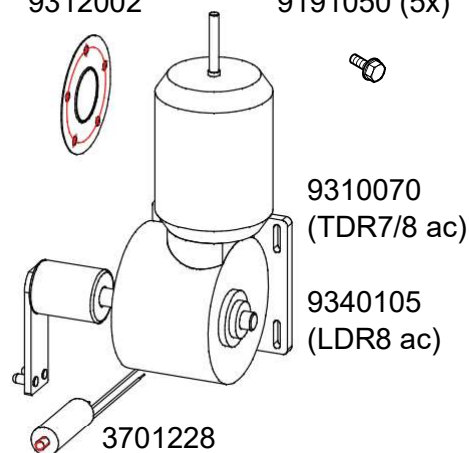

Contents service kit 9340105s for LDR8 ac:

9340105	1x	Ass. rotor drive
3701228	1x	Capacitor 2,5 µF
9312002	1x	Shaft seal 5 holes
9314202	1x	Silicone dis Ø100
9191050	5x	Hexagon screw M5x18
9123719	1x	This instruction

The instruction is applicable for the following Deli Rotisserie models:

- TDR7/8i auto clean
- TDR7/8s auto clean
- TDR7+7s/8+8s auto clean
- LDR8s auto clean

TDR7/8i ac



TDR7+7s/8+8s ac



LDR8s ac



- NOTICE -

This manual is prepared for the use of trained Service Technicians and should not be used by those not properly qualified. If you have attended a training for this product, you may be qualified to perform all the procedures in this manual.

This manual is not intended to be all encompassing. If you have not attended a training for this product, you should read, in its entirety, the repair procedure you wish to perform to determine if you have the necessary tools, instruments and skills required to perform the procedure. Procedures for which you do not have the necessary tools, instruments and skills should be performed by a trained technician.

Reproduction or other use of this Manual, without the express written consent of Fri-Jado, is prohibited.

Doc. Nr.	Rev.	Registration form.
		<b>Service instruction replacement</b>
<b>9123719</b>	<b>0</b>	<b>rotor drive motor TDR7/8 ac + LDR8 ac</b>



DISCONNECT THE UNIT FROM THE POWER SUPPLY BEFORE STARTING THIS PROCEDURE!

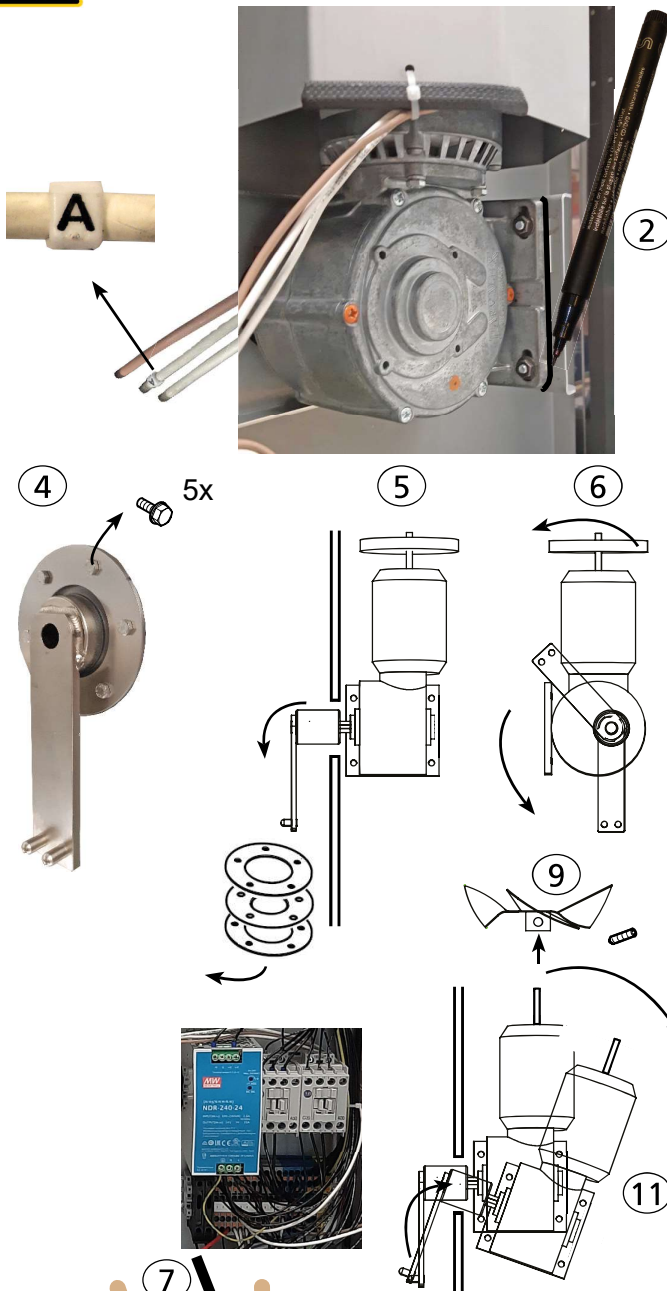

Dismounting the rotor motor:

1. Remove the side panel at the operator panel side.
2. Mark the position of the motor on the bracket.
3. Take the rotor shaft out of the cooking cavity.
4. Unscrew the 5 screws from the shaft seal mounting plate.
5. Slide the mounting plate, shaft seal and silicone disc from the drive arm.
6. Put the drive arm (If applicable) in the position as shown. This can be done manually, if necessary, by turning the fan blade on the motor.
7. Disconnect the wiring of the motor.
8. Unscrew 4 screws and put the air guide aside.
9. Remove the (cooling) fan blade.
10. Unscrew the 4 mounting screws with nuts of the motor.
11. Take out the motor as shown.

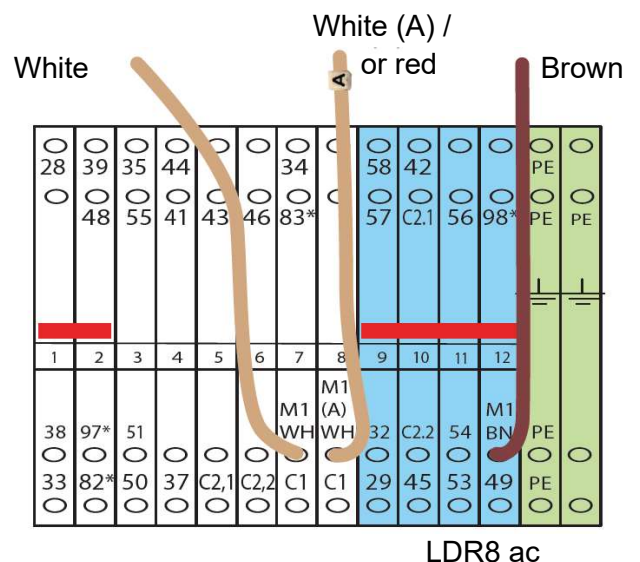
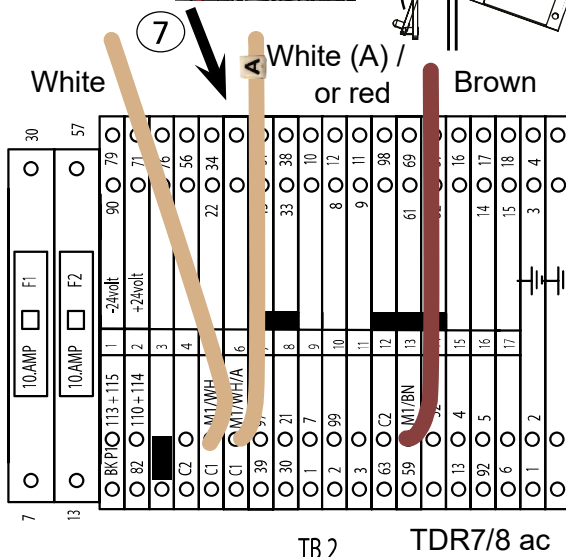

Doc. Nr.	Rev.	Registration form.
		<b>Service instruction replacement</b>
<b>9123719</b>	<b>0</b>	<b>rotor drive motor TDR7/8 ac + LDR8 ac</b>

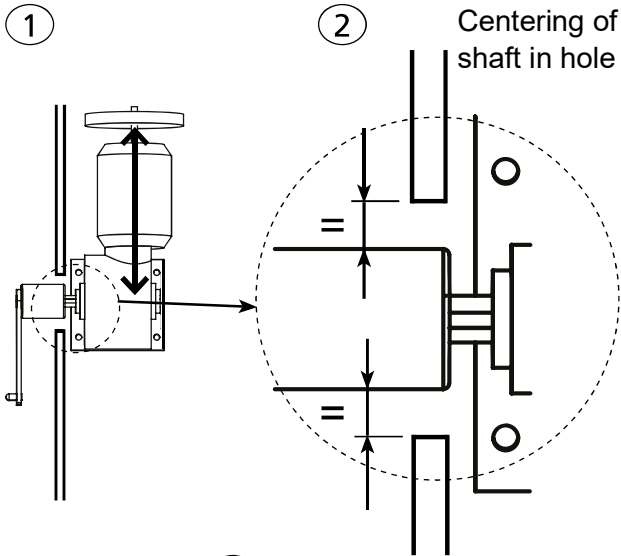

#### Mounting the rotor motor

1. Mount the motor on the bracket using the previous made mark (see #2 from disassembling).
2. The motor shaft should come through the center of the hole!!
3. Connect the wiring of the (new) motor. See previous page for position of wires.

*In case the wires have receptacles mounted, then these have to be cut off and the wires stripped. Note that the white wire, marked "A" is longer. On later models this wire is replaced by a red wire.*

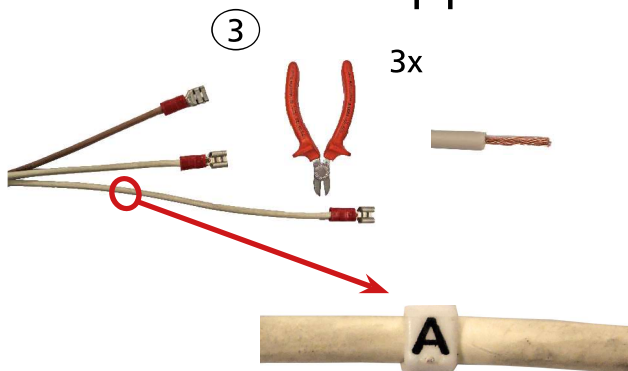

4. Hook in the rotor and check the axial play. This should be 2,5 -3mm (3/32"-4/32").
5. Put power on the unit and test the rotation of the rotor. Interchange the two white wires if wrong. The air flow should go up!
6. Check if the drive arm in top position has the same distance to the side wall as in bottom position.
7. Mount the new silicone disc and shaft seal when the position of the motor is ok and the screws are mounted tight.

